



Cold liquid waterproofing and surfacing



# Kemper System

world-leading waterproofing and surfacing solutions

**Kemper System offer a complete waterproofing and surfacing solution using specially formulated, cold liquid-applied resins to produce a membrane that provides total protection in the most demanding applications.**

New build or repair, there will be a Kemper product offering reliable, long term protection that you can specify with complete confidence - whatever the substrate or application.

This includes flat roofs, balconies, terraces and walkways through to car parks. There are Kemper products suited for internal applications and wet rooms, fountains and water features... whilst our low-odour, solvent-free waterproofing and surfacing avoids the need to evict occupants during repairs or refurbishment.

Kemperol waterproofing is fabricated on site using specially engineered resins that provide excellent workability and curing - some systems are water-resistant and able to withstand foot traffic within 60 minutes of application.

This, together with the exceptionally strong, tear-resistant polyester fleece, creates a tough, seamless membrane that bonds fully to almost all substrates. Terminations, penetrations and upstands are finished quickly and more reliably than with other systems, offering better performance as well as being highly cost-effective.

And with our comprehensive technical support, detailing, model specifications, design advice and full regional support on site, you can be assured of a fully professional service from concept to completion.

## System benefits

- Fully permeable, elastic membrane
- Wet-on-wet application gives better performance
- Purpose-engineered, specialist resins
- Strong, tear-resistant polyester fleece
- Allows old roof repair without removal
- Permanently bonds to all substrates
- Complex detailing easily and quickly finished on site
- New build or repair
- Solvent-free or rapid curing options
- Warm and cold roofs, inverted roofs, green roofs
- Range of slip-resistant surfaces



## System build-up

*Kemperol is a liquid resin-based waterproofing system with a matched range of slip-resistant Kemperdur surfacing products. It offers many advantages over other flat roof systems or hot-applied methods and is the only cold liquid waterproofing system applied 'wet on wet'.*

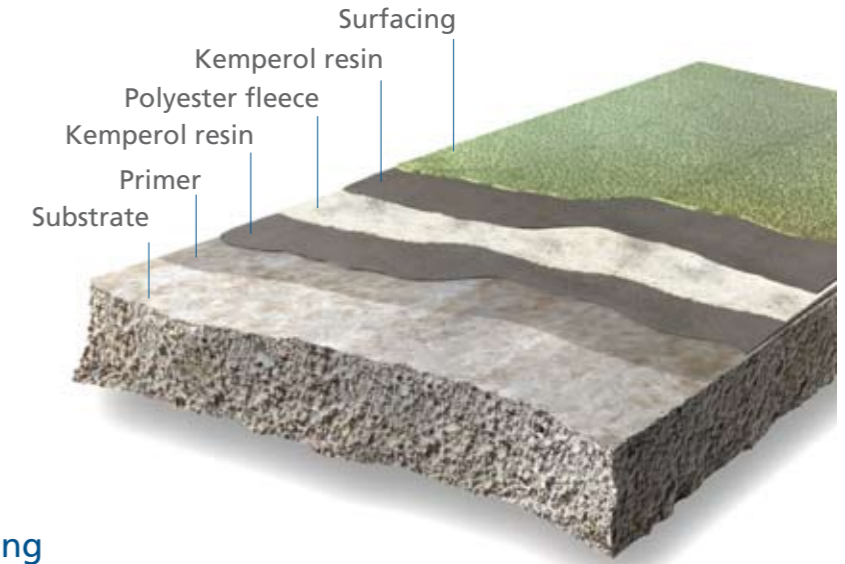

## Kemperol waterproofing

Kemperol is the world's leading cold-applied waterproofing system. It is available in four different formulations, including the solvent-free, low-odour Kemperol 2K-PUR. These include one, two and three-component products, each designed for specific applications rather than the 'one size fits all' approach of other systems available.

All have essentially the same build up, comprising technically advanced resins impregnating a strong, tear-resistant polyester fleece to form a tough, permeable membrane that bonds permanently to almost any substrate.

## Kemperdur surfacing

Kemperdur surfacing can be used as a stand-alone, slip-resistant wearing course over a wide range of new or existing substrates carrying pedestrian or vehicular traffic, including roads and car-parks.

It may also be used in conjunction with Kemperol waterproofing products to provide a durable, long-lasting surface for more heavily trafficked areas such as walkways, podiums and balconies. It is available in a range of colours, textures and finishes.

## Why 'wet on wet' is best...

Kemperol is the only cold liquid applied waterproofing that is applied 'wet on wet'.

This method offers superior performance over 'wet on dry' and allows installation to be completed more cost-effectively, more quickly and more reliably for better long-term performance.

### Typical 2-layer, 'wet on dry' waterproofing

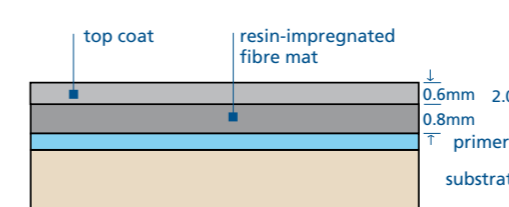

### Kemperol single layer, 2-coat waterproofing

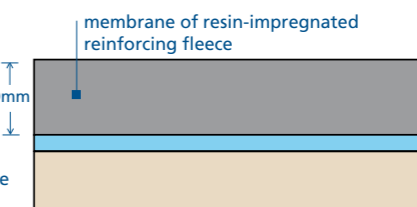



# Kemperol waterproofing

**Kemperol is a complete, cold liquid resin-based waterproofing system, offering many advantages over partially bonded or hot-applied methods. It is also a dedicated system, ideal for repair or newbuild, using specific products for specific applications - unlike the 'one size fits all' solutions typically available elsewhere.**



## Exceptional performance

The key to the exceptional performance of a Kemperol waterproofing membrane is its technically superior resin - the result of decades of research, engineering and technical development.

Most liquid-applied systems offer just one resin - a single solution whatever the application. Contrast this to Kemperol with its range of dedicated resins - each developed to optimise performance under different conditions and specific applications. This includes the UK's only solvent-free cold liquid waterproofing. And only Kemperol resins can be applied 'wet on wet' - a method that gives superior performance, speeds installation and provides an ultra-strong bond to almost any substrate.

## Ideal for new-build...

Modern roofs are increasingly complex, housing various HVAC plant and fixtures, drainage, safety barriers, rooflights and gantries. Creating and terminating such details with traditional waterproofing materials is not only time consuming, but in practice is by far the most vulnerable component leading to roof failure. Whatever the material, the Kemperol membrane bonds *in situ* to upstands and penetrations - quickly, easily... and permanently.

## ... and perfectly suited for repair

Kemperol specially formulated resins will bond easily to almost all existing roof materials, including asphalt, bitumen, GRP, PVC, TPO and EPDM. This allows failed roofs to be quickly and permanently repaired - often without having to remove the existing membrane, saving on time and disposal costs.



## Sustainability

Kemperol 2K-PUR is the UK's only solvent-free cold liquid waterproofing and also uses resin with an 80% renewable component, sourced from vegetable oil. The Kemperol polyester fleece used for all products has a 25% recycled content, whilst the product range also includes solvent-free primer and surfacing products. Because Kemperol permanently bonds to most substrates it is usually unnecessary to remove and dispose of failed materials on repair projects - reducing waste, transport and landfill. There is no compromise on performance with solvent-free products, which have the same ease of installation, BBA certification and a 30-year expected working life.



## Kemperol V210

A polyester-based system that forms a permanently elastic, seamless, yet highly permeable membrane. Extremely durable and tear-resistant, it can accommodate structural details and penetrations without the need for additional mechanical fixings and is particularly suitable for complex roofs that would typically prove difficult to waterproof. Also suited for green roofs, warm roofs and permanently immersed areas such as fountains and water features.

## Kemperol 2K-PUR

Kemperol 2K-PUR is solvent-free and odourless, making it suitable for use on occupied buildings where solvent-based products would be highly disruptive or require evacuation, such as schools, hospitals, food manufacturing and internal areas. A 2-component polyurethane-based product, it forms a permanently elastic, seamless, yet highly permeable membrane that is both durable and tear-resistant.

## Kemperol 1K-PUR

Applied straight from the can to form a permanently elastic, seamless membrane it is ideal for long term waterproofing of awkward roof details such as penetrations, upstands and gutters. These characteristics also make it ideal for areas with difficult or restricted access and for the long term protection of balconies and terraces.

## Kemperol AC

A rapid-curing waterproofing and surfacing product used for internal and external applications. Permanently elastic, it is particularly suitable for walkways, balconies and areas subject to heavy traffic, including carparks. It is also suitable for waterproofing structural elements that are subject to movement.

Certification	Product		
FM	V210		
BBA	V210	2K-PUR	
EOTA	V210	2K-PUR	1K-PUR



# Kemperol waterproofing and surfacing...



## New-build flat roofing

Kemperol cold liquid waterproofing with its tough, tear-resistant polyester reinforcing fleece bonds to all substrates to create a tough, reliable membrane that is permanently elastic and will withstand maintenance foot traffic.

## Flat roof repairs

Easily applied, Kemperol is a reliable, long term solution to failed roofs and because it bonds to existing materials, costly removal and disposal is avoided. The option of solvent-free, odourless 2K-PUR ensures minimal disruption to building tenants.

## Detailing

Penetrations and upstands are easily waterproofed in situ, becoming an integral part of the roof membrane and without the need for adhesive or mechanically fixed terminations - the main cause of roof failures with traditional materials.

## Rooflights

Atriums and pavement rooflights are notoriously difficult to waterproof or repair. Kemperol 1K-PUR does this with ease, with Kemperdur FGC (transparent) providing slip-resistance on glazed areas.

## Balconies

Kemperdur surfacing can be applied onto all Kemperol waterproofing membranes, giving a highly durable, slip-resistant finish for balconies and walkways. Hard landscaping materials can also be applied, including tiles, paving slabs and decking.

## Terraces and podiums

Kemperol materials are widely used to waterproof and surface podiums, terraces, walkways and external carparks - demonstrating their exceptional versatility, durability and reliability.

## Pitched roof repairs

Kemperol can be used on pitched roofs to repair failed asbestos, metal, copper or lead. Reliable and cost-effective, it forms a fully bonded waterproofing membrane that cures leaks, seals laps and fixings and rejuvenates appearance.

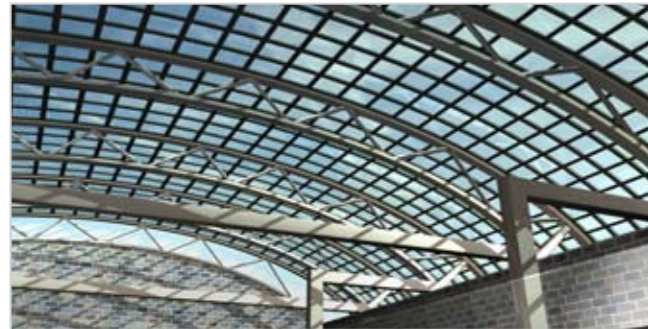

# ... so many uses and applications

## Roof repairs: gutters

Kemperol is ideal for repairing leaking valley gutters, forming a seamless membrane along the gutter length that seals joints, fixings and penetrations. Outlets are easily waterproofed and, being flexible, it will accommodate thermal or structural movement.

## Internal rooms

Internal wet rooms or banded areas can be fully waterproofed with Kemperol and can be surfaced in a range of finishes or materials. Kemperol 2K-PUR is solvent-free and low-odour, so can be applied with minimum disruption to occupants or other trades working on site.

## Warm roofs

Stratex is Kemper's integrated warm roofing system, comprising vapour barrier, insulation and waterproofing. It will accommodate maintenance foot traffic and can be finished with Kemperdur surfacing or decorative landscaping materials where more frequent foot traffic is expected.

## Green roofs

Stratex is also the warm roof element in the KemperGreen roofing system, which can be used for both intensive or extensive planting schemes, with paving and decking options giving a wide choice of 'roofscape' design options.

## Fountains and water features

The integrity and performance of Kemperol waterproofing materials - even in permanently immersed conditions - is highlighted by its suitability for lining water features and fountains.

## Car parks and stairways

For heavily trafficked applications, including both internal and external carparks and stairways, Kemperdur surfacing can be applied either direct to the substrate or onto a Kemperol waterproof membrane in a range of finished colours.

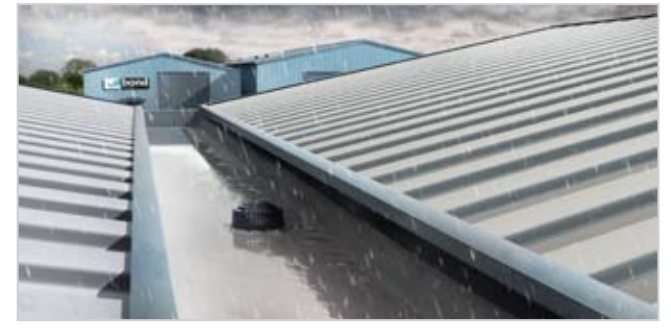



## Kemperdur surfacing

**Kemperdur anti-slip surfacing products can form an integral part of a complete system where combined waterproofing and surfacing is required. It can also be applied directly onto primed concrete or screed for a tough, resilient surface on areas subject to traffic that do not need to be waterproofed.**

### Vehicular or pedestrian

Slip-resistant Kemperdur surfacing products are exceptionally hard-wearing, and suitable for all applications from balconies and walkways through to ramps and carparks.

### Solvent-free and fast curing

The Kemperdur range includes solvent-free, low odour products which are easy to apply and site-friendly. It also offers rapid-curing options which minimise disruption and can be walked on within an hour of application.

### Wide choice of colours...

Kiln-dried quartz sand can be specified in a choice of colours, applied directly onto the Kemperol membrane as it cures, before sealing with a transparent, UV-resistant topcoat. Alternatively natural quartz can be specified with a coloured topcoat. A choice of standard colours is available as well as RAL and BS options (subject to minimum quantities).

### ... and surface finishes too

In addition to our traditional quartz anti-slip surfacing, more contemporary finishes are available in both silk and gloss, as well as a decorative range.

### New or existing substrates

Kemperdur surfacings can be applied over most new or existing substrates, so they are equally suited to newbuild or refurbishment. This can sometimes eliminate the need to remove failed materials, saving on time, transport and disposal costs.

### Kemperdur AC

A rapid curing surface, textured with a quartz sand coating that has excellent slip resistance and can withstand foot traffic within one hour of application. Designed for most outdoor applications, it may be used as a waterproofing surface (with fleece reinforcement) or as a high-build finish on its own

#### *Kemperdur AC coloured finish*

This pigmented topcoat is applied with Natural Quartz for a cost-effective coloured finish, with the further option of RAL and BS colours also available (minimum quantities apply).

#### *Kemperdur Coloured Quartz*

Alternatively a coloured, slip-resistant finish can be achieved using a pigmented quartz (standard colours Anthracite or Slate, with RAL or BS colours also available). It is then finished with a transparent, UV-resistant topcoat.

### Kemperdur TC (solvent-free)

This solvent-free surfacing is quartz sand-based, giving a decorative, textured finish applied directly onto primed substrates or any Kemperol waterproofing. Its hard-wearing, slip-resistant surface is ideal for balconies and walkways. It is sealed with a UV-resistant topcoat and, being low odour, it is also ideal for internal use.

### Kemperdur HB

This polyurethane resin uses fine fillers to give a high build (2-4mm) finish that is exceptionally durable and is ideal for pedestrian areas or to cover small cracks, joints or surface irregularities.

### Kemperdur Deko

Deko is a UV-stable polyurethane coating that can be applied straight from the can. Available in three colours, its slip-resistant surface has a relatively smooth finish offering a more contemporary appearance that is easily cleaned and maintained.

The solvent-free version, *Kemperdur Deko 2K*, is particularly suited for internal applications, or with Kemperol 2K-PUR where a high-performance solvent-free waterproofing system is preferred.

### Kemperdur FGC

This is a transparent coating for glazed surfaces, designed to seal cracks, finish details or provide an anti-slip surfacing for pavement roof lights. Its greater viscosity also makes it suitable for applications where the surface finish extends to include upstands.

### Coewell

A cost-effective, water-based acrylic coating that encapsulates the entire roof where Kemperol has been used for patch repairs, giving a uniform appearance and protective finish.

### Key benefits

- Wide range of surfacing options from pedestrian to vehicular
- Curing times from just 60 minutes
- Solvent-free products available
- Range of colours and finishes
- Use as part of waterproofing system or stand-alone surfacing
- Permanently flexible, hard-wearing and durable



# Technical support and services

**When you choose a Kemper waterproofing or surfacing system, you'll get comprehensive design and technical support from start to finish.**

And because no two jobs are ever the same, we work with you to identify the most suitable, cost-effective and reliable waterproofing solution for your project, ensuring your design objectives are fully met.

Our experienced design team can provide technical advice, supply NBS specifications and recommend suitable details to ensure the long term performance of specified materials.

You'll get full support from our sales team in the field, who'll be able to offer experienced advice, recommend solutions and liaise directly with your installation contractor to help with the smooth running of your project.

We also have a team of technical specialists who, as well as providing site training and contractor support, work closely with specifiers on active projects to help troubleshoot design challenges and advise on repair solutions for failed roofs.

- Expert advice and support from experienced technical design team
- NBS specifications
- CAD drawings for tapered roofs
- Site visits arranged
- UK-wide project support from specialist technical teams
- Installed only by Kemper-trained and approved contractors



## NBS Specifications

We can supply full NBS specifications for your project, which will be verified by our technical team to ensure the products specified are the most appropriate for the design and practical requirements of the particular application. This will be dependent on the substrate as well as other detailed performance and project objectives. Kemperol, unlike many cold liquid systems, is not a 'one size fits all' solution, and is designed for the specific demands of the application.

## Design support

We can produce U-value calculations, condensation risk analyses and, if required, supply section drawings to support your design specification. We also provide bespoke tapered insulation schemes, with CAD drawings, for tapered Stratex warm roofs.

## Site visits

Once your project is underway, we can arrange site visits as required to ensure your contractor is fully supported and materials are delivered on time and to specification.



## Installation and service

Kemper system waterproofing and surfacing products are installed only by fully trained, independent contractors who have completed a specialist training programme and are certified and approved by Kemper.

This ensures the quality of installation matches the quality and performance of the Kemper product, and is backed by our comprehensive 15 or 20-year waterproofing warranty.

Site visits are undertaken as necessary and additional on-site support by our technical team will be arranged where any special treatment or detailing is required.

This personalised service, the option of a choice of waterproofing and surfacing products and our ability to offer bespoke solutions for specific applications means users are assured of a more durable, long-lasting and reliable system.

## Further Information

For further technical or product information, please contact our technical team on 01925 445532 or visit our website at [www.kempersystem.co.uk](http://www.kempersystem.co.uk).

## Kemper worldwide

Kemper System UK  
Kemper System Ltd.  
[www.kempersystem.co.uk](http://www.kempersystem.co.uk)

Kemper System Germany  
Kemper System GmbH & Co. KG  
[www.kemper-system.com](http://www.kemper-system.com)

Kemper System USA  
Kemper System Inc.  
[www.kempersystem.net](http://www.kempersystem.net)

Kemper System France  
Kemper System s.r.l.  
[www.kempersystem.fr](http://www.kempersystem.fr)

Kemper System Italy  
Kemper System Italia s.r.l.  
[www.kempersystem.it](http://www.kempersystem.it)

Kemper System India  
Kemper System Pvt. Ltd.  
[www.kemperindia.com](http://www.kemperindia.com)

Kemper System China  
Kemper System  
Liquid Coating & Sealing Co. Ltd.  
[www.kempersystem.com.cn](http://www.kempersystem.com.cn)



### KEMPER SYSTEM LTD

Kemper House, Mill Lane, Winwick Quay,  
Warrington, Cheshire WA2 8RJ

Tel: 01925 445532 Fax: 01925 575096

Email: [enquiries@kempersystem.co.uk](mailto:enquiries@kempersystem.co.uk)

Web: [www.kempersystem.co.uk](http://www.kempersystem.co.uk)